

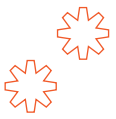

\*\*\*

# PRODUCT CATALOGUE

PRODUCT OF  DURAVAZ



# Table of Content



P.04	What is DuraLink (Product of Duravaz)?
P.05	ANSI Short Pitch Precision Roller Chains – Simplex
P.06	ANSI Short Pitch Precision Roller Chains – Duplex
P.07	ANSI Short Pitch Precision Roller Chains – Triplex
P.08	BS Short Pitch Precision Roller Chains – Simplex
P.09	BS Short Pitch Precision Roller Chains – Duplex
P.10	BS Short Pitch Precision Roller Chains – Triplex
P.11	Stainless Steel Roller Chains and Attachments
P.12	ANSI Roller Chains with Straight Side Plates
P.13	BS Roller Chains with Straight Side Plates
P.14	Double Pitch Conveyor Chains
P.15	Double Pitch Conveyor Chains with Attachments
P.16	Double Pitch Conveyor Chains with Attachments
P.17	Double Pitch Conveyor Chains with Attachments
P.18	Double Pitch Conveyor Chains with Extended Pins
P.19	Stainless Steel Double Pitch Conveyor Chains with Attachments
P.20	Lubricants
P.21	Chain-Driven Power



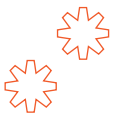

# What is Duralink?



Chains are widely used in bicycles, motorcycles, personal mobility devices, and various industrial equipments since they provide reliable, efficient, and long-lasting power transmission with relatively low economic cost.

As a member of **DURAVAZ** family of power transmission products, **DURALINK** offers broad range of quality industrial chains. **DURALINK** is the ultimate durable yet cost efficient - chain based - drive system solution. To ensure reliability, only quality materials are in use, along with uncompromised technical precision in the manufacturing process. Please refer to the technical details to get the best of your **DURALINK** industrial chains. **DURALINK** ensures the drive system will run smoothly and get the job done to achieve optimum manufacturing productivity.

## Chain Constructions and Components



# ANSI Short Pitch Precision Roller Chains

## SIMPLEX

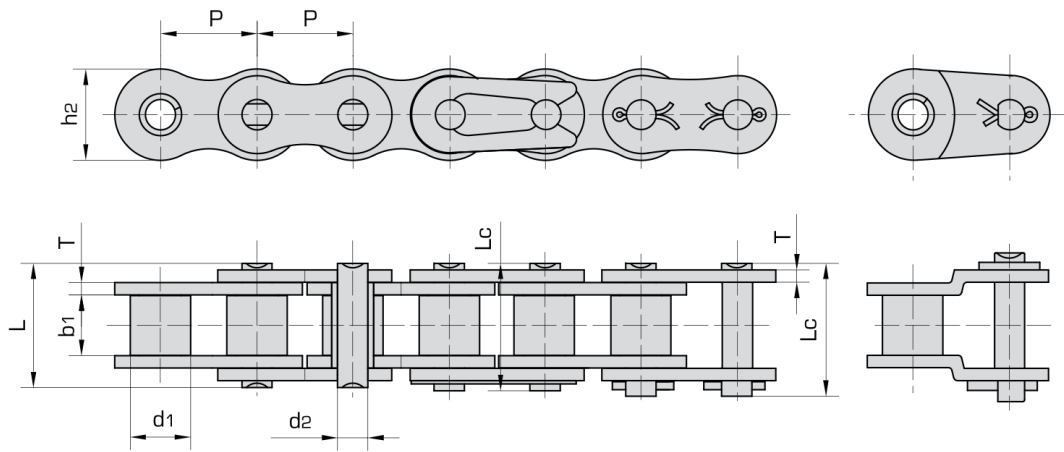

ANSI Number	Pitch (P)	Roller Diameter (d1)	Width between Inner Plate (b1)	Pin Diameter (d2)	Pin Length (L)	Pin Length (Lc)	Inner Plate Depth (h2)	Plate Thickness (t/T)	Ultimate Tensile Strength (Q)	Average Tensile Strength (Qo)	Dynamic Strength	Weight
	max	max mm	min mm	max mm	max mm	max mm	max mm	max mm	max mm	kN	kN	kg/m
35	9.525	5.08	4.68	3.60	13.2	16.5	9.05	1.27	7.9	10.3	14.1	0.33
40	12.70	7.92	7.85	3.98	17.8	21.7	12.07	1.52	13.9	17.0	24.8	0.60
50	15.875	10.16	9.40	5.09	21.8	25.9	15.09	2.03	21.8	28.0	38.5	1.00
60	19.05	11.91	12.57	5.96	26.9	31.5	18.10	2.39	31.3	40.0	54.9	1.50
80	25.40	15.88	15.75	7.94	33.5	38.9	24.13	3.18	55.6	66.0	95.5	2.60
100	31.75	19.05	18.90	9.54	41.1	47.2	30.17	3.96	87.0	104.0	146	3.70
120	38.10	22.23	25.22	11.11	50.8	57.4	36.20	4.75	125.0	148.0	205	5.5
140	44.45	25.40	25.22	12.71	54.9	62.3	42.23	5.56	170.0	201.0	273	7.50
160	50.80	28.58	31.55	14.29	65.5	73.4	48.26	6.35	223.0	265.0	348	9.70
180	57.15	35.71	35.48	17.46	73.9	83.0	54.30	7.14	281.0	325.0	445	13.45
200	63.5	39.88	37.85	19.85	80.3	90.5	60.33	7.92	347.0	410.0	536	15.60
240	76.20	47.63	47.35	23.81	95.5	106.0	72.39	9.52	500.0	591.0	731	22.60

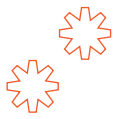

# ANSI Short Pitch Precision Roller Chains

## DUPLEX

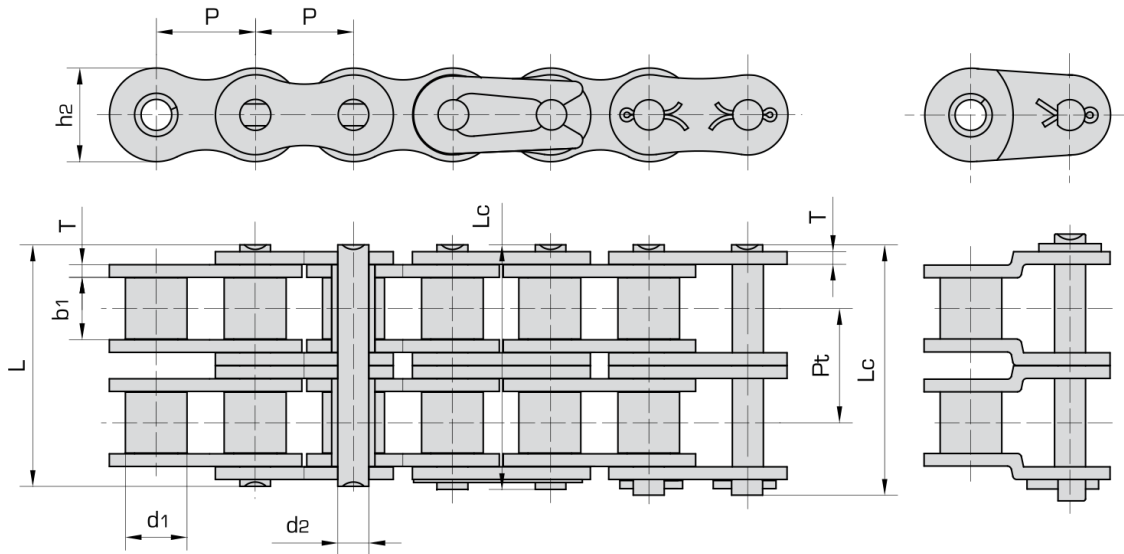

ANSI Number	Pitch (P)	Roller Diameter (d1)	Width between Inner Plate (b1)	Pin Diameter (d2)	Pin Length (L)	Pin Length (Lc)	Inner Plate Depth (h2)	Transverse pitch (pt)	Plate Thickness (t/T)	Ultimate Tensile Strength (Q)	Average Tensile Strength (Qo)	Weight
	max	max mm	min mm	max mm	max mm	max mm	max mm		max mm	min kN	kN	kg/m
40-2	12.70	7.92	7.85	3.98	32.3	36.2	12.07	14.38	1.52	27.8	34.0	1.20
50-2	15.875	10.16	9.40	5.09	39.9	44.0	15.09	18.11	2.03	43.6	55.0	1.90
60-2	19.05	11.91	12.57	5.96	49.8	54.4	18.10	22.78	2.39	62.6	80.0	2.90
80-2	25.40	15.88	15.75	7.94	62.7	68.1	24.13	29.29	3.18	111.2	135.0	5.00
100-2	31.75	19.05	18.90	9.54	77.0	83.1	30.17	35.76	3.96	174.0	208.0	7.30
120-2	38.10	22.23	25.22	11.11	96.3	102.9	36.20	45.44	4.75	250.0	299.0	10.90
140-2	44.45	25.40	25.22	12.71	103.6	111.0	42.23	48.87	5.56	340.0	406.0	14.40
160-2	50.80	28.58	31.55	14.29	124.2	132.1	48.26	58.55	6.35	446.0	534.0	19.00
180-2	57.15	35.71	35.48	17.46	140.0	149.1	54.30	65.84	7.14	562.0	660.0	26.52
200-2	63.50	39.68	37.85	19.85	151.9	162.1	60.33	71.55	7.92	694.0	834.0	32.00
240-2	76.2	47.63	47.35	23.81	183.4	193.9	72.39	87.83	9.52	1000.0	1193.0	44.00

# ANSI Short Pitch Precision Roller Chains

## TRIPLEX

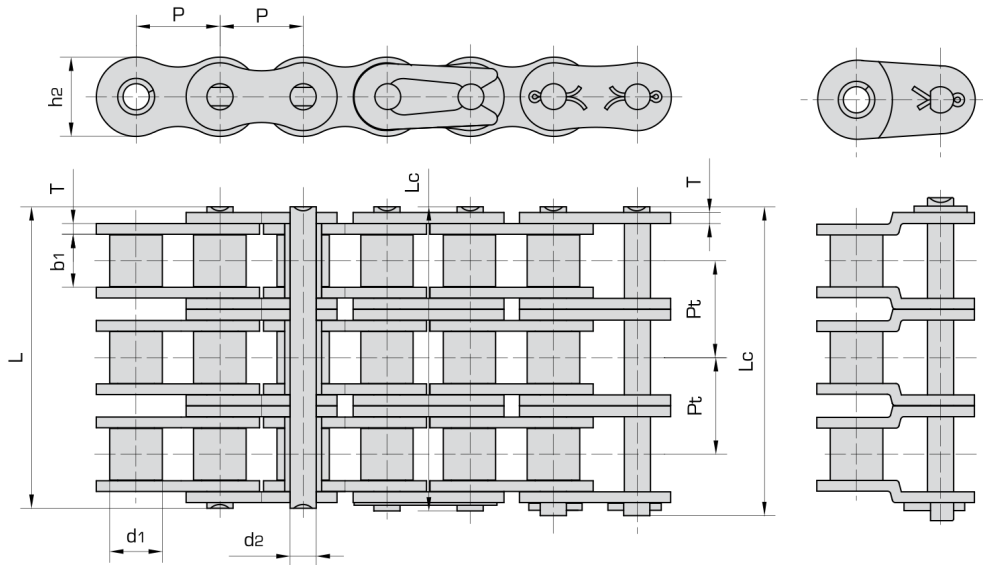

ANSI Number	Pitch (P)	Roller Diameter (d1)	Width between Inner Plate (b1)	Pin Diameter (d2)	Pin Length (L)	Pin Length (Lc)	Inner Plate Depth (h2)	Transverse pitch (pt)	Plate Thickness (t/T)	Ultimate Tensile Strength (Q)	Average Tensile Strength (Qo)	Weight
	max	max mm	min mm	max mm	max mm	max mm	max mm	max mm	min kN	kN	kN	kg/m
35-3	9.525	5.08	4.68	3.60	33.5	36.8	9.05	10.13	1.27	23.7	27.2	1.05
40-3	12.70	7.92	7.85	3.98	46.7	50.6	12.07	14.38	1.52	41.7	47.5	1.80
50-3	15.875	10.16	9.40	5.09	57.9	62.0	15.09	18.11	2.03	65.4	74.0	2.90
60-3	19.05	11.91	12.57	5.96	72.6	77.2	18.10	22.78	2.39	93.9	106.0	4.30
80-3	25.40	15.88	15.75	7.94	91.9	97.3	24.13	29.29	3.18	166.8	188.5	7.50
100-3	31.75	19.05	18.9	9.54	113.0	119.1	30.17	35.76	3.96	261.0	294.0	11.00
120-3	38.10	22.23	25.22	11.11	141.7	148.3	36.20	45.44	4.75	375.0	415.0	16.50
140-3	44.45	25.40	25.22	12.71	152.4	159.8	42.23	48.87	5.56	510.0	564.0	21.7
160-3	50.80	28.58	31.55	14.29	182.9	190.8	48.26	58.55	6.35	669.0	742.0	28.30
180-3	57.15	35.71	35.48	17.46	206.0	215.1	54.30	65.84	7.14	843.0	934.0	38.22
200-3	63.50	39.68	37.85	19.85	223.5	233.7	60.33	71.55	7.92	1041.0	1157.0	48.00
240-3	76.20	47.63	47.35	23.81	271.3	281.8	72.39	87.83	9.52	1500.0	1669.0	66.00

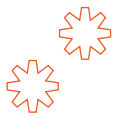

# BS Short Pitch Precision Roller Chains

## SIMPLEX

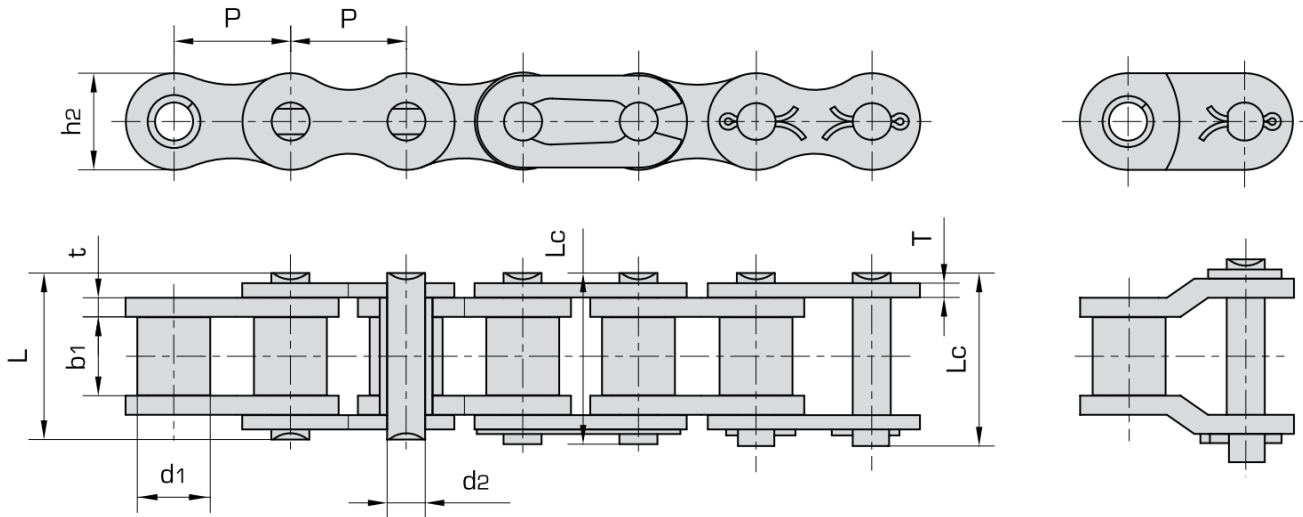

ISO Number	Pitch (P)	Roller Diameter (d1)	Width between Inner Plate (b1)	Pin Diameter (d2)	Pin Length (L)	Pin Length (Lc)	Inner Plate Depth (h2)	Plate Thickness (t/T)	Ultimate Tensile Strength (Q)	Average Tensile Strength (Qo)	Dynamic Strength	Weight
	max	max mm	min mm	max mm	max mm	max mm	max mm	max mm	min kN	min kN	kN	kg/m
05B-1	8.00	5.00	3.00	2.31	8.60	11.7	7.11	0.80	4.4	5.6	8.2	0.18
06B-1*	9.525	6.35	5.72	3.28	13.50	16.8	8.26	1.30	8.9	9.9	12.9	0.41
08B-1	12.70	8.51	7.75	4.45	17.00	20.9	11.81	1.60	17.8	18.4	24.8	0.70
10B-1	15.875	10.16	9.65	5.08	19.60	23.7	14.73	1.70	22.2	26.1	33.3	0.95
12B-1	19.05	12.07	11.68	5.72	22.7	27.3	16.13	1.85	28.9	30.6	37.2	1.25
16B-1	25.40	15.88	17.02	8.28	36.10	41.5	21.08	4.15/3.1	60.0	69.2	95.3	2.70
20B-1	31.75	19.05	19.56	10.19	43.20	49.3	26.42	4.5/3.5	95.0	101.0	135.0	3.60
24B-1	38.10	25.40	25.40	14.63	53.40	60.0	33.40	6.0/4.8	160.0	169.0	197.0	6.70
28B-1	44.45	27.94	30.99	15.90	65.10	72.5	37.08	7.5/6.0	200.0	211.0	271.0	8.30
32B-1	50.80	29.21	30.99	17.81	67.40	75.3	42.29	7.0/6.0	250.0	263.0	299.0	10.50
40B-1	63.50	39.37	38.10	22.89	82.6	92.8	52.96	8.5/8.0	355.0	374.0	418.0	16.00
48B-1	76.20	48.26	45.72	29.24	99.10	109.6	63.88	12.0/10.0	560.0	590.0	636.0	25.00

\*Straight side plates



# BS Short Pitch Precision Roller Chains

## DUPLEX

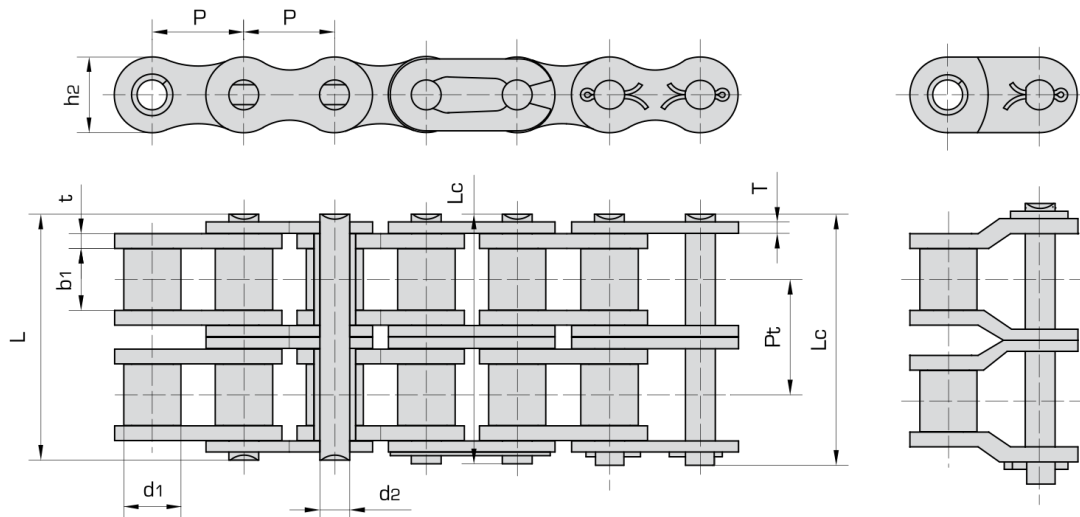

ISO Number	Pitch (P)	Roller Diameter (d1)	Width between Inner Plate (b1)	Pin Diameter (d2)	Pin Length (L)	Pin Length (Lc)	Inner Plate Depth (h2)	Transverse pitch (pt)	Plate Thickness (t/T)	Ultimate Tensile Strength (Q)	Average Tensile Strength (Qo)	Weight
	max	max mm	min mm	max mm	max mm	max mm	max mm		max mm	min kN	kN	kg/m
05B-2	8.00	5.00	3.00	2.31	14.3	17.4	7.11	5.64	0.8	7.8	9.7	0.36
06B-2*	9.525	6.35	5.72	3.28	23.8	27.1	8.26	10.24	1.30	16.9	17.8	0.78
08B-2	12.70	8.51	7.75	4.45	31.0	34.9	11.81	13.92	1.60	31.1	36.8	1.35
10B-2	15.875	10.16	9.65	5.08	36.2	40.3	14.73	16.59	1.70	44.5	53.4	1.80
12B-2	19.05	12.07	11.88	5.72	42.2	46.8	16.13	19.46	1.85	57.8	62.8	2.50
16B-2	25.40	15.88	17.02	8.28	68.0	73.4	21.08	31.88	4.15/3.1	106.0	126.0	5.40
20B-2	31.75	19.05	19.56	10.19	79.7	85.8	26.42	36.45	4.5/4.5	170.0	200.0	7.20
24B-2	38.10	25.40	25.40	14.63	101.8	108.4	33.40	48.36	6.0/4.8	280.0	303.0	13.50
28B-2	44.45	27.94	30.99	15.90	124.7	132.1	37.08	59.56	7.5/6.0	360.0	386.0	16.60
32B-2	50.80	29.21	30.99	17.81	126.0	133.0	42.29	58.55	7.0/6.0	450.0	483.0	21.00
40B-2	63.50	39.37	38.10	22.89	154.9	165.1	52.96	72.29	8.5/8.0	630.0	676.0	32.00
48B-2	76.20	48.26	45.72	29.24	190.4	200.9	63.88	91.21	12.0/10.0	1000.0	1073.0	50.00

\*Straight side plates

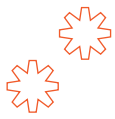

# BS Short Pitch Precision Roller Chains

## TRIPLEX

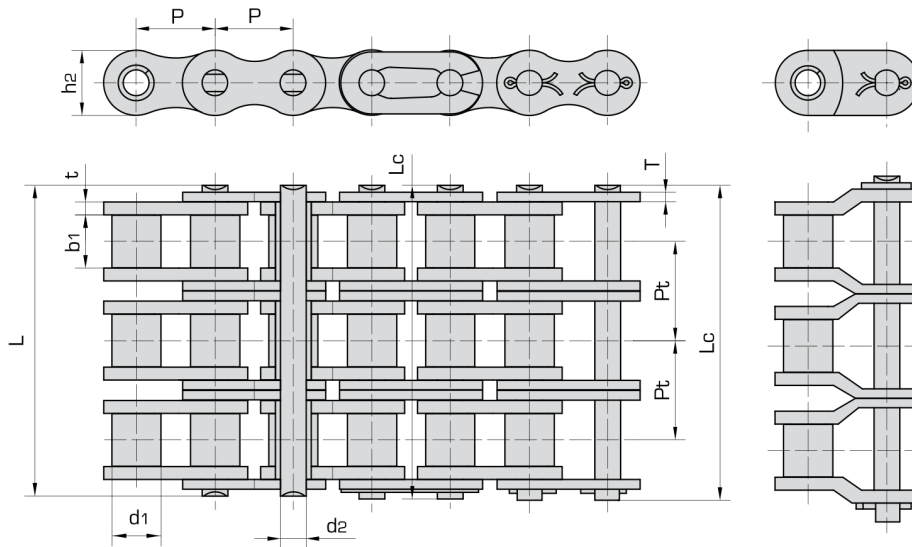

ISO Number	Pitch (P)	Roller Diameter (d1)	Width between Inner Plate (b1)	Pin Diameter (d2)	Pin Length (L)	Pin Length (Lc)	Inner Plate Depth (h2)	Transverse pitch (pt)	Plate Thickness (t/T)	Ultimate Tensile Strength (Q)	Average Tensile Strength (Qo)	Weight
	max	max mm	min mm	max mm	max mm	max mm	max mm		max mm	min kN	kN	kg/m
05B-3	8.00	5.00	3.00	2.31	19.9	23.0	7.11	5.64	0.80	11.1	13.1	0.54
06B-3*	9.525	6.35	5.72	3.28	34.0	37.3	8.26	10.24	1.30	24.9	28.6	1.18
08B-3	12.70	8.51	7.75	4.45	44.9	48.8	11.81	13.92	1.60	44.5	54.9	2.00
10B-3	15.875	10.16	9.65	5.08	52.80	56.90	14.73	16.59	1.70	66.7	80.3	2.80
12B-3	19.05	12.07	11.88	5.72	61.7	66.3	16.13	19.46	1.85	86.7	96.7	3.80
16B-3	25.40	15.88	17.02	8.28	99.9	105.3	21.08	31.88	4.15/3.1	160.0	193.0	8.00
20B-3	31.75	19.05	19.56	10.19	116.1	122.2	26.42	36.45	4.5/3.5	250.0	275.0	11.00
24B-3	38.10	25.40	25.40	14.63	150.2	156.8	33.40	48.36	6.0/4.8	425.0	468.0	21.00
28B-3	44.45	27.94	30.99	15.90	184.3	191.7	37.08	59.56	7.5/6.0	530.0	579.0	25.00
32B-3	50.80	29.21	30.99	17.81	184.5	191.5	42.29	58.55	7.0/6.0	670.0	732.0	32.00
40B-3	63.50	39.37	38.10	22.89	227.2	237.4	52.96	72.29	8.5/8.0	950.0	1038.0	48.00
48B-3	76.20	48.26	45.72	29.24	281.6	292.1	63.88	91.21	12.0/10.0	1500.0	1624.0	75.00

\*Straight side plates

# Stainless Steel Roller Chains and Attachments

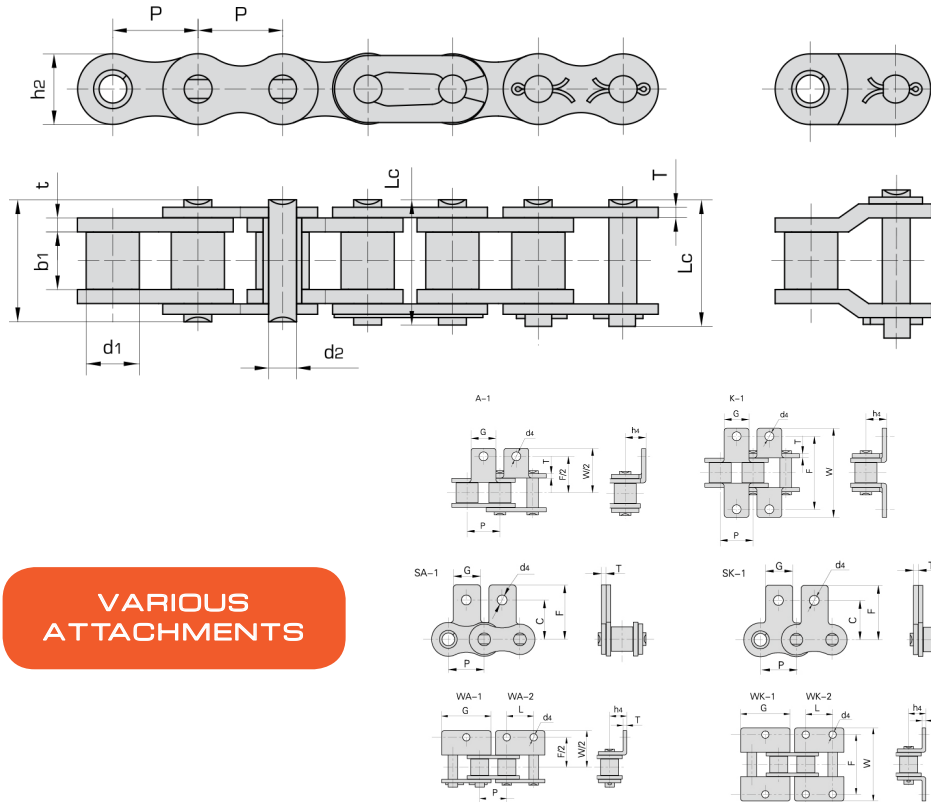

**VARIOUS  
ATTACHMENTS**

ISO Number	ANSI Number	Pitch (P)	Roller Diameter (d1)	Width between Inner Plate (b1)	Pin Diameter (d2)	Pin Length (L)	Pin Length (Lc)	Inner Plate Depth (h2)	Plate Thickness (t/T)	Ultimate Tensile Strength (Q)	Average Tensile Strength (Qo)	Weight
		max	max mm	min mm	max mm	max mm	max mm	max mm	max mm	min kN	kN	Kg/M
	25SS	6.350	3.30	3.18	2.31	7.90	8.40	6.00	0.80	2.50	2.8	0.15
	35SS	9.525	5.08	4.77	3.58	12.40	13.17	9.00	1.30	5.50	6.6	0.33
	40SS	12.700	7.95	7.85	3.96	16.60	17.80	12.00	1.50	9.60	10.8	0.63
	50SS	15.875	10.16	9.40	5.08	20.70	22.20	15.09	2.03	15.20	17.2	1.03
	60SS	19.050	11.91	12.57	5.94	25.90	27.70	18.00	2.42	21.70	26.4	1.51
	80SS	25.400	15.88	15.75	7.92	32.70	35.00	24.00	3.25	38.90	46.6	2.62
	100SS	31.750	19.05	18.90	9.53	40.40	44.70	30.00	4.00	60.00	70.2	3.94
	120SS	38.100	22.23	25.22	11.10	50.30	54.30	35.70	4.80	88.90	104.8	5.72
	O4BSS	6.000	4.00	2.80	1.85	6.80	7.80	5.00	0.60	2.00	2.4	0.11
	O5BSS	8.000	5.00	3.00	2.31	8.20	8.90	7.10	0.80	3.50	4.1	0.20
	#06BSS	9.525	6.35	5.72	3.28	13.15	14.10	8.20	1.30	6.20	6.8	0.41
	O8BSS	12.700	8.51	7.75	4.45	16.70	18.20	11.80	1.60	12.00	14.3	0.70
	10BSS	15.875	10.16	9.65	5.08	19.50	20.90	14.70	1.70	14.50	17.2	0.94
	12BSS	19.050	12.07	11.68	5.72	22.50	24.20	16.00	1.85	18.50	20.9	1.16
	16BSS	25.400	15.88	17.02	8.28	36.10	37.40	21.00	4.15/3.10	40.00	47.6	2.73
	20BSS	31.750	19.05	19.56	10.19	41.30	45.00	26.40	4.50/3.50	59.00	69.6	3.73
	24BSS	38.100	25.40	25.40	14.63	53.40	57.80	33.20	6.00/4.80	112.00	126.6	7.20

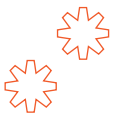

# ANSI Roller Chains with Straight Side Plates

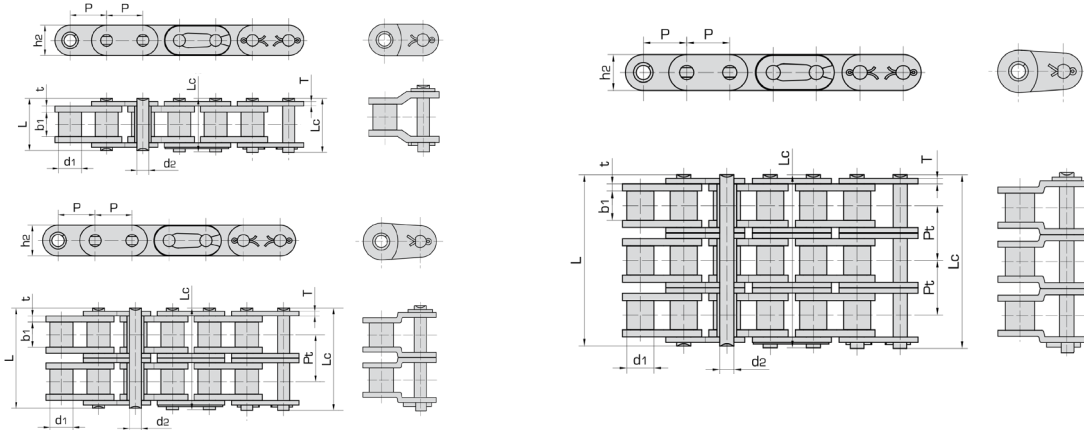

ANSI Number	Pitch (P)	Roller Diameter (d1)	Width between Inner Plate (b1)	Pin Diameter (d2)	Pin Length (L)	Pin Length (Lc)	Inner Plate Depth (h2)	Plate Thickness (t/T)	Transverse Pitch (pt)	Ultimate Tensile Strength (Q)	Average Tensile Strength (Qo)	Weight
	max	max mm	min mm	max mm	max mm	max mm	max mm	max mm		min kN	kN	kg/m
C35*	9.525	5.08	4.77	3.58	13.30	14.30	9.00	1.30	-	7.90	10.8	0.41
C40	12.700	7.95	7.85	3.96	16.60	18.80	12.00	1.50	-	14.10	17.5	0.73
C50	15.875	10.16	9.40	5.08	20.70	23.30	15.09	2.03	-	22.20	29.4	1.23
C60	19.050	11.91	12.57	5.94	25.90	28.30	18.00	2.42	-	31.80	41.5	1.81
C80	25.400	15.88	15.75	7.92	32.70	36.50	24.00	3.25	-	56.70	69.4	3.09
C 100	31.750	19.05	18.90	9.53	40.40	44.70	30.00	4.00	-	88.50	109.2	4.56
C 120	38.100	22.23	25.22	11.10	50.30	54.30	35.70	4.80	-	127.00	156.3	6.86
C 140	44.450	25.40	25.22	12.70	54.40	59.00	41.00	5.60	-	172.40	212.0	8.49
C 160	50.800	28.58	31.55	14.27	64.80	69.60	47.80	6.40	-	226.80	278.9	11.50
C 40-2	12.700	7.95	7.85	3.96	31.00	33.20	12.00	1.50	14.38	28.20	35.9	1.43
C 50-2	15.875	10.16	9.40	5.08	38.90	41.40	15.09	2.03	18.11	44.40	58.1	2.42
C 60-2	19.050	11.91	12.57	5.94	48.80	51.10	18.00	2.42	22.78	63.60	82.1	3.58
C 80-2	25.400	15.88	15.75	7.92	62.70	65.80	24.00	3.25	29.29	113.40	141.8	6.12
C 100-2	31.750	19.05	18.90	9.53	76.40	80.50	30.00	4.00	35.76	177.00	219.4	9.08
C 120-2	38.100	22.23	25.22	11.10	95.80	99.70	35.70	4.80	45.44	254.00	314.9	13.60
C 140-2	44.450	25.40	25.22	12.70	103.30	107.90	41.00	5.60	48.87	344.80	427.5	16.86
C 160-2	50.800	28.58	31.55	14.27	123.30	128.10	47.80	6.40	58.55	453.60	562.4	22.90
C 40-3	12.700	7.95	7.85	3.96	45.40	47.60	12.00	1.50	14.38	42.30	50.0	2.14
C 50-3	15.875	10.16	9.40	5.08	57.00	59.50	15.09	2.03	18.11	66.60	77.8	3.62
C 60-3	19.050	11.91	12.57	5.94	71.50	73.90	18.00	2.42	22.78	95.40	111.1	5.36
C 80-3	25.400	15.88	15.75	7.92	91.70	95.10	24.00	3.25	29.29	170.10	198.4	9.10
C 100-3	31.750	19.05	18.90	9.53	112.20	116.30	30.00	4.00	35.76	265.50	309.6	13.60
C 120-3	38.100	22.23	25.22	11.10	141.40	145.20	35.70	4.80	45.44	381.00	437.2	20.43
C 140-3	44.450	25.40	25.22	12.70	152.20	156.80	41.00	5.60	48.87	517.20	593.3	25.23
C 160-3	50.800	28.58	31.55	14.27	181.80	186.60	47.80	6.40	58.55	680.40	780.6	34.19

\* Bushing Chain: d1 in the table indicate the external diameter of the bushing

# BS Roller Chains with Straight Side Plates

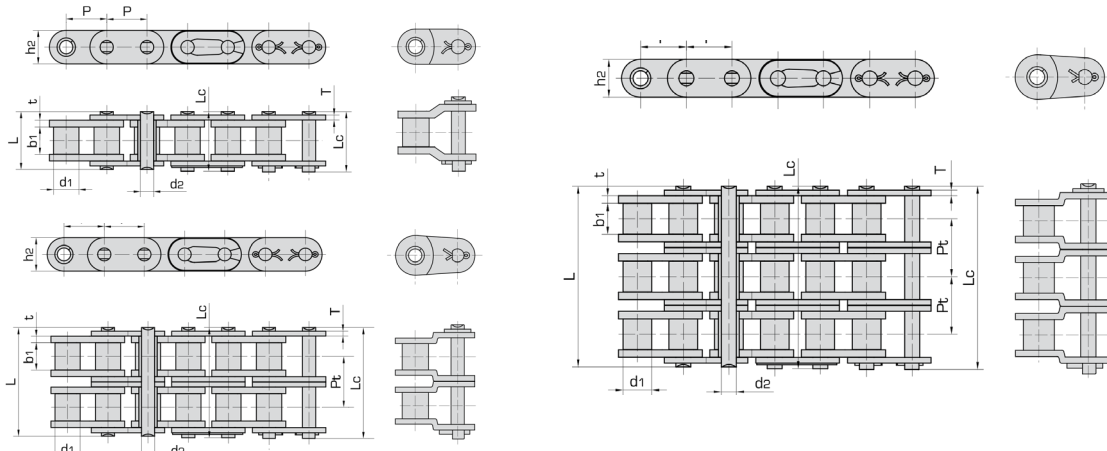

ANSI Number	Pitch (P)	Roller Diameter (d1)	Width between Inner Plate (b1)	Pin Diameter (d2)	Pin Length (L)	Pin Length (Lc)	Inner Plate Depth (h2)	Plate Thickness (t/T)	Transverse Pitch (pt)	Ultimate Tensile Strength (Q)	Average Tensile Strength (Qo)	Weight
	max	max mm	min mm	max mm	max mm	max mm	max mm	max mm		min kN	kN	kg/m
C08B-1	12.700	8.51	7.75	4.45	16.70	18.20	11.80	1.60	-	18.00	19.5	0.80
C10B-1	15.875	10.16	9.65	5.08	19.50	20.90	14.70	1.70	-	22.40	27.9	1.06
C12B-1	19.050	12.07	11.68	5.72	22.50	25.20	16.00	1.85	-	29.00	32.2	1.32
C16B-1	25.400	15.88	17.02	8.28	36.10	39.10	21.00	4.15/3.10	-	60.00	72.8	3.08
C20B-1	31.750	19.05	19.56	10.19	41.30	45.00	26.40	4.50/3.50	-	95.00	106.7	4.16
C24B-1	38.100	25.40	25.40	14.63	53.40	57.80	33.20	6.00/4.80	-	160.00	178.0	7.47
C28B-1	44.450	27.94	30.99	15.90	65.10	69.50	36.70	7.50/6.00	-	200.00	222.0	9.90
C32B-1	50.800	29.21	30.99	17.81	66.00	71.00	42.00	7.00/6.00	-	250.00	277.5	10.45
C08B-2	12.700	8.51	7.75	4.45	31.20	32.20	11.80	1.60	13.92	32.00	38.7	1.45
C10B-2	15.875	10.16	9.65	5.08	36.10	37.50	14.70	1.70	16.59	44.50	57.8	2.00
C12B-2	19.050	12.07	11.68	5.72	42.00	44.70	16.00	1.85	19.46	57.80	66.1	2.62
C16B-2	25.400	15.88	17.02	8.28	68.00	71.00	21.00	4.15/3.10	31.88	106.00	133.0	6.10
C20B-2	31.750	19.05	19.56	10.19	77.80	81.50	26.40	4.50/3.50	36.45	170.00	211.2	8.23
C24B-2	38.100	25.40	25.40	14.63	101.70	106.20	33.20	6.00/4.80	48.36	280.00	319.2	14.77
C28B-2	44.450	27.94	30.99	15.90	124.60	129.10	36.70	7.50/6.00	59.56	360.00	406.8	19.82
C32B-2	50.800	29.21	30.99	17.81	124.60	129.60	42.00	7.00/6.00	58.55	450.00	508.5	20.94
C08B-3	12.700	8.51	7.75	4.45	45.10	46.10	11.80	1.60	13.92	47.50	57.8	2.10
C10B-3	15.875	10.16	9.65	5.08	52.70	54.10	14.70	1.70	16.59	66.70	84.5	2.87
C12B-3	19.050	12.07	11.68	5.72	61.50	64.20	16.00	1.85	19.46	86.70	101.8	3.89
C16B-3	25.400	15.88	17.02	8.28	99.80	102.90	21.00	4.15/3.10	31.88	160.00	203.7	9.12
C20B-3	31.750	19.05	19.56	10.19	114.20	117.90	26.40	4.50/3.50	36.45	250.00	290.0	11.34
C24B-3	38.100	25.40	25.40	14.63	150.10	154.60	33.20	6.00/4.80	48.36	425.00	493.0	22.10
C28B-3	44.450	27.94	30.99	15.90	184.20	188.70	36.70	7.50/6.00	59.56	530.00	609.5	29.64
C32B-3	50.800	29.21	30.99	17.81	183.20	188.20	42.00	7.00/6.00	58.55	670.00	770.5	31.27



# Double Pitch Conveyor Chains

Small Roller Type

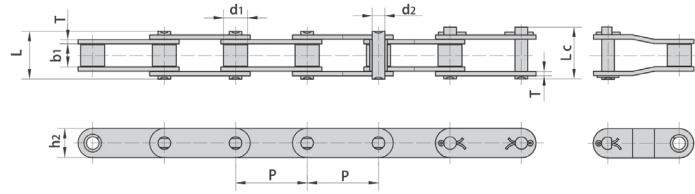

Large Roller Type

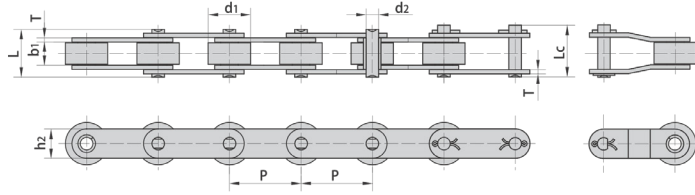

GB ISO DIN	ANSI Number	Pitch (P)	Roller Diameter (d1)	Width between Inner Plate (b1)	Pin Diameter (d2)	Pin Length (L)	Pin Length (Lc)	Inner Plate Depth (h2)	Plate Thickness (t/T)	Ultimate Tensile Strength (Q)	Weight
		max	max mm	min mm	max mm	max mm	max mm	max mm	max mm	min kN	kg/m
C208A	C2040	25.4	7.95	7.85	3.98	17.80	21.70	12.07	1.52	13.9	0.50
C208AL	C2042	25.4	15.88	7.85	3.98	17.80	21.70	12.07	1.52	13.9	0.84
C208B		25.4	8.51	7.75	4.45	17.00	20.90	11.81	1.60	17.80	0.55
C208BL		25.4	15.88	7.75	4.45	17.00	20.90	11.81	1.60	17.80	0.89
C210A	C2050	31.75	10.16	9.40	5.09	21.80	25.90	15.09	2.03	21.80	0.78
C210AL	C2052	31.75	19.05	9.40	5.09	21.80	25.90	15.09	2.03	21.80	1.27
C212A	C2060	38.1	11.91	12.57	5.96	26.90	31.50	18.10	2.39	31.30	1.12
C212AL	C2062	38.1	22.23	12.57	5.96	26.90	31.50	18.10	2.39	31.30	1.61
C212AH	C2060H	38.1	11.91	12.57	5.96	30.20	34.80	18.10	3.18	31.30	1.44
C212AHL	C2062H	38.1	22.23	12.57	5.96	30.20	34.80	18.10	3.18	31.30	2.07
C216A	C2080	50.8	15.88	15.75	7.94	33.50	38.90	24.13	3.18	55.60	2.08
C216AL	C2082	50.8	28.58	15.75	7.94	33.50	38.90	24.13	3.18	55.60	3.12
C216AH	C2080H	50.8	15.88	15.75	7.94	37.40	42.80	24.13	3.96	55.60	2.54
C216AHL	C2082H	50.8	28.58	15.75	7.94	37.40	42.80	24.13	3.96	55.60	3.58
C220A	C2100	63.5	19.05	18.90	9.54	41.10	47.20	30.17	3.96	87.00	3.01
C220AL	C2102	63.5	39.67	18.90	9.54	41.10	47.20	30.17	3.96	87.00	4.83
C220AH	C2100H	63.5	19.05	18.90	9.54	44.50	50.60	30.17	4.75	87.00	3.56
C220AHL	C2102H	63.5	39.67	18.90	9.54	44.50	50.60	30.17	4.75	87.00	5.38
C224A	C2120	76.2	22.23	25.22	11.11	50.80	57.40	36.20	4.75	125.00	4.66
C224AL	C2122	76.2	44.45	25.22	11.11	50.80	57.40	36.20	4.75	125.00	7.66
C224AH	C2120H	76.2	22.23	25.22	11.11	55.00	61.60	36.20	5.56	125.00	5.26
C224AHL	C2122H	76.2	44.45	25.22	11.11	55.00	61.60	36.20	5.56	125.00	8.26
C232A	C2160	101.6	28.58	31.55	14.29	65.50	73.40	48.26	6.35	222.4	8.15
C232AL	C2162	101.6	57.15	31.55	14.29	65.50	73.40	48.26	6.35	222.4	13.00
C232AH	C2160H	101.6	28.58	31.55	14.29	69.40	77.30	48.26	7.14	222.4	9.06
C232AHL	C2162H	101.6	57.15	31.55	14.29	69.40	77.30	48.26	7.14	222.4	13.84

# Double Pitch Conveyor Chains with Attachments

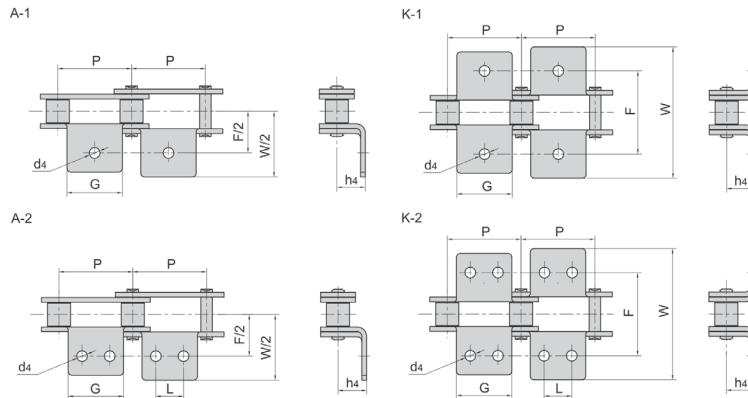

GB ISO DIN	ANSI Number	Pitch (P)	G	L	F	W	h4	d4
		max	max mm	min mm	max mm	max mm	max mm	max mm
C208A	C2040	25.4	19.1	9.5	25.4	39.6	9.1	3.4
C208AL	C2042	25.4	19.1	9.5	25.4	39.6	9.1	3.4
C208B		25.4	23.2	12.7	25.4	39.6	9.1	4.5
C208BL		25.4	23.2	12.7	25.4	39.6	9.1	4.5
C210A	C2050	31.75	23.8	11.9	31.8	49	11.1	5.5
C210AL	C2052	31.75	23.8	11.9	31.8	49	11.1	5.5
C212A	C2060	38.1	28.6	14.3	42.9	67.8	14.7	5.5
C212AL	C2062	38.1	28.6	14.3	42.9	67.8	14.7	5.5
C212AH	C2060H	38.1	28.6	14.3	42.9	67.8	14.7	5.5
C212AHL	C2062H	38.1	28.6	14.3	42.9	67.8	14.7	5.5
C216A	C2080	50.8	38.1	19.1	55.6	87.8	19.1	6.8
C216AL	C2082	50.8	38.1	19.1	55.6	87.8	19.1	6.8
C216AH	C2080H	50.8	38.1	19.1	55.6	87.8	19.1	6.8
C216AHL	C2082H	50.8	38.1	19.1	55.6	87.8	19.1	6.8
C220A	C2100	63.5	47.6	23.8	66.6	107.5	23.4	9.2
C220AL	C2102	63.5	47.6	23.8	66.6	107.5	23.4	9.2
C220AH	C2100H	63.5	47.6	23.8	66.6	107.5	23.4	9.2
C220AHL	C2102H	63.5	47.6	23.8	66.6	107.5	23.4	9.2
C224A	C2120	76.2	57.2	28.6	79.3	121.4	27.8	11
C224AL	C2122	76.2	57.2	28.6	79.3	121.4	27.8	11
C224AH	C2120H	76.2	57.2	28.6	79.3	121.4	27.8	11
C224AHL	C2122H	76.2	57.2	28.6	79.3	121.4	27.8	11
C232A	C2160	101.6	76.2	38.1	104.7	151.6	36.5	13.1
C232AL	C2162	101.6	76.2	38.1	104.7	151.6	36.5	13.1
C232AH	C2160H	101.6	76.2	38.1	104.7	151.6	36.5	13.1
C232AHL	C2162H	101.6	76.2	38.1	104.7	151.6	36.5	13.1



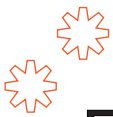

# Double Pitch Conveyor Chains with Attachments

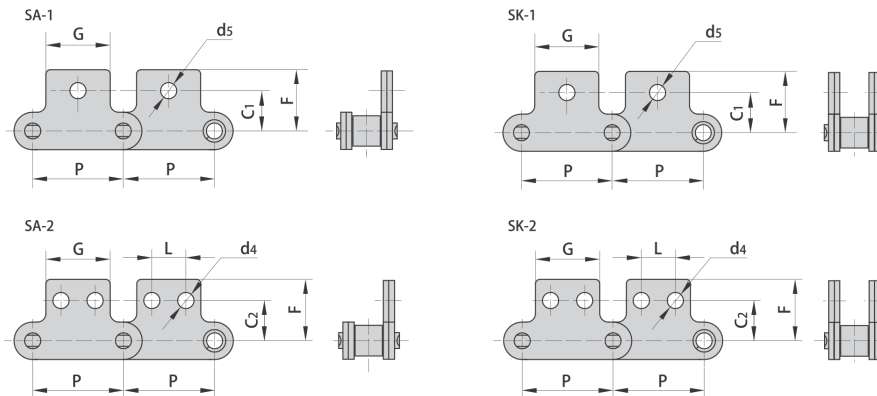

GB ISO DIN	ANSI Number	Pitch (P)	G	L	C1	C2	F	d4	d5
		max	max mm	min mm	max mm	max mm	max mm	max mm	max mm
C208A	C2040	25.4	19.1	9.5	11.1	13.50	20.5	3.4	5.5
C208AL	C2042	25.4	19.1	9.5	11.1	13.50	20.5	3.4	5.5
C208B		25.4	23.2	12.7	11.1	13.50	20.5	4.5	5.5
C208BL		25.4	23.2	12.7	11.1	13.50	20.5	4.5	5.5
C210A	C2050	31.75	23.8	11.9	14.3	15.90	25.0	5.5	6.6
C210AL	C2052	31.75	23.8	11.9	14.3	15.90	25.0	5.5	6.6
C212A	C2060	38.1	28.6	14.3	17.5	19.10	32.9	5.5	9.2
C212AL	C2062	38.1	28.6	14.3	17.5	19.10	32.9	5.5	9.2
C212AH	C2060H	38.1	28.6	14.3	17.5	19.10	32.9	5.5	9.2
C212AHL	C2062H	38.1	28.6	14.3	17.5	19.10	32.9	5.5	9.2
C216A	C2080	50.8	38.1	19.1	22.2	25.40	43.5	6.6	11
C216AL	C2082	50.8	38.1	19.1	22.2	25.40	43.5	6.6	11
C216AH	C2080H	50.8	38.1	19.1	22.2	25.40	43.5	6.6	11
C216AHL	C2082H	50.8	38.1	19.1	22.2	25.40	43.5	6.6	11
C220A	C2100	63.5	47.6	23.8	28.6	31.8	50.4	8.4	13
C220AL	C2102	63.5	47.6	23.8	28.6	31.8	50.4	8.4	13
C220AH	C2100H	63.5	47.6	23.8	28.6	31.8	50.4	8.4	13
C220AHL	C2102H	63.5	47.6	23.8	28.6	31.8	50.4	8.4	13



# Double Pitch Conveyor Chains with Attachments

SAA-1

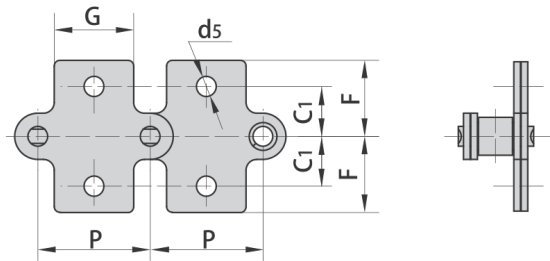

SKK-1

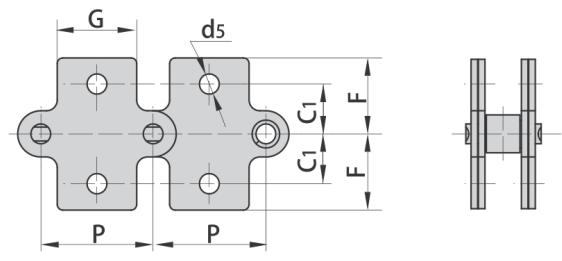

SAA-2

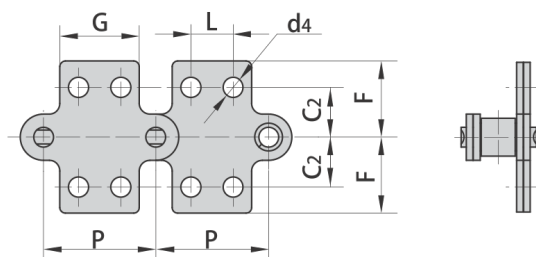

SKK-2

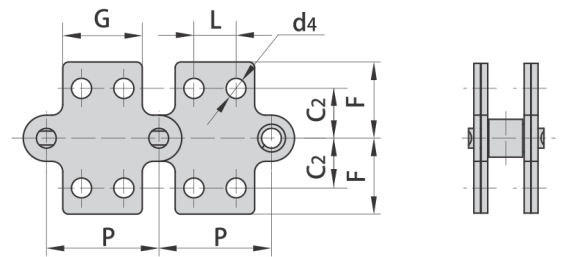

ISO Number	ANSI Number	Pitch (P)	G	L	C1	C2	F	d4	d5
		max	max mm	min mm	max mm	max mm	max mm	max mm	max mm
C208A	C2040	25.400	19.10	9.50	11.10	13.50	20.50	3.40	5.50
C208AL	C2042	25.400	19.10	9.50	11.10	13.50	20.50	3.40	5.50
C208B		25.400	23.20	12.70	11.10	13.50	20.50	4.50	5.50
C208BL		25.400	23.20	12.70	11.10	13.50	20.50	4.50	5.50
C210A	C2050	31.750	23.80	11.90	14.30	15.90	25.00	5.50	6.60
C210AL	C2052	31.750	23.80	11.90	14.30	15.90	25.00	5.50	6.60
C212A	C2060	38.100	28.60	14.30	17.50	19.10	32.90	5.50	9.20
C212AL	C2062	38.100	28.60	14.30	17.50	19.10	32.90	5.50	9.20
C212AH	C2060H	38.100	28.60	14.30	17.50	19.10	32.90	5.50	9.20
C212AHL	C2062H	38.100	28.60	14.30	17.50	19.10	32.90	5.50	9.20
C216A	C2080	50.800	38.10	19.10	22.20	25.40	43.50	6.60	11.00
C216AL	C2082	50.800	38.10	19.10	22.20	25.40	43.50	6.60	11.00
C216AH	C2080H	50.800	38.10	19.10	22.20	25.40	43.50	6.60	11.00
C2216AHL	C2082H	50.800	38.10	19.10	22.20	25.40	43.50	6.60	11.00





# Double Pitch Conveyor Chains with Attachments

AA-1

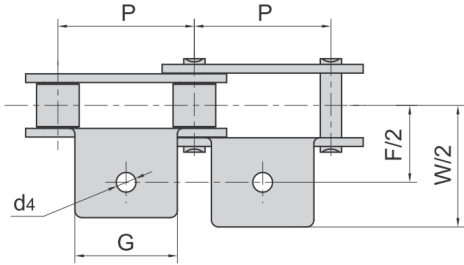

AA-2

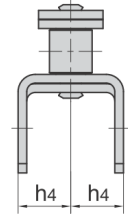
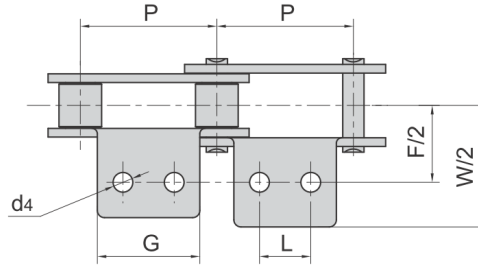

KK-1

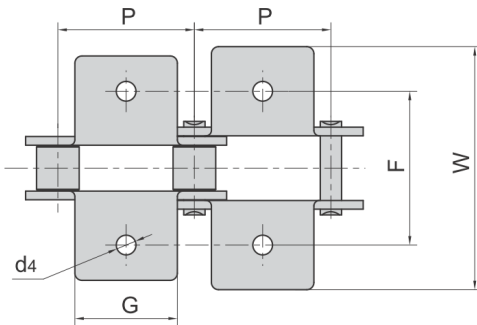

KK-2

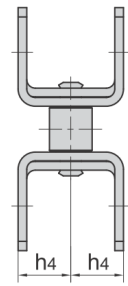
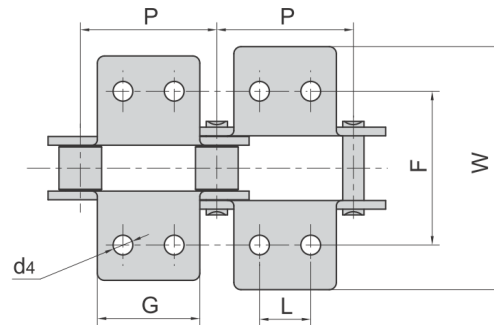

ISO Number	ANSI Number	Pitch (P)	G	L	F	W	h4	d4
		max mm	max mm	min mm	max mm	max mm	max mm	max mm
C208A	C2040	25.400	19.10	9.50	25.40	39.60	9.10	3.40
C208AL	C2042	25.400	19.10	9.50	25.40	39.60	9.10	3.40
C208B		25.400	23.20	12.70	25.40	39.60	9.10	4.50
C208BL		25.400	23.20	12.70	25.40	39.60	9.10	4.50
C210A	C2050	31.750	23.80	11.90	38.10	49.00	11.10	5.50
C210AL	C2052	31.750	23.80	11.90	38.10	49.00	11.10	5.50
C212A	C2060	38.100	28.60	14.30	42.90	67.80	14.70	5.50
C212AL	C2062	38.100	28.60	14.30	42.90	67.80	14.70	5.50
C212AH	C2060H	38.100	28.60	14.30	42.90	67.80	14.70	5.50
C212AHL	C2062H	38.100	28.60	14.30	42.90	67.80	14.70	5.50
C216A	C2080	50.800	38.10	19.10	55.60	87.80	19.10	6.80
C216AL	C2082	50.800	38.10	19.10	55.60	87.80	19.10	6.80
C216AH	C2080H	50.800	38.10	19.10	55.60	87.80	19.10	6.80
C2216AHL	C2082H	50.800	38.10	19.10	55.60	87.80	19.10	6.80

# Double Pitch Conveyor Chains with Extended Pins

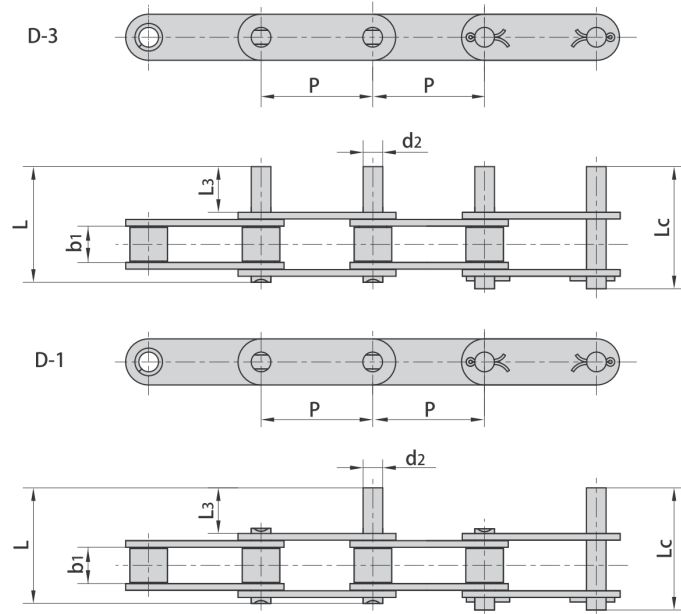

GB ISO DIN	ANSI Number	Pitch (P)	b1	d2	L3	L	LC
C208A	C2040	25.4	7.85	3.96	9.5	25.1	26.2
C208AL	C2042	25.4	7.85	3.96	9.5	25.1	26.2
C210A	C2050	31.75	9.40	5.09	11.9	31.3	33.1
C210AL	C2052	31.75	9.40	5.09	11.9	31.3	33.1
C212A	C2060	38.10	12.57	5.96	14.3	38.6	40.6
C212AL	C2062	38.10	12.57	5.96	14.3	38.6	40.6
C212AH	C2060H	38.10	12.57	5.96	14.3	42	43.8
C212AHL	C2062H	38.10	12.57	5.96	14.3	42	43.8
C216A	C2080	50.80	15.75	7.94	19.1	50.3	53.3
C216AL	C2082	50.80	15.75	7.94	19.1	50.3	53.3
C216AH	C2080H	50.80	15.75	7.94	19.1	53.5	55
C216AHL	C2082H	50.80	15.75	7.94	19.1	53.5	55
C220A	C2100	63.50	18.90	9.54	23.8	61.8	66.1
C220AL	C2102	63.50	18.90	9.54	23.8	61.8	66.1
C220AH	C2100H	63.50	18.90	9.54	23.8	65	68.3
C220AHL	C2102H	63.50	18.90	9.54	23.8	65	68.3
C224AH	C2120H	76.20	25.22	11.11	28.6	79.6	83.6
C224AHL	C2122H	76.20	25.22	11.11	28.6	79.6	83.6
C232AH	C2160H	101.6	31.75	14.27	38.1	103	107.8
C232AHL	C2162H	101.6	31.75	14.27	38.1	103	107.8

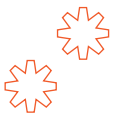

# Stainless Steel Double Pitch Conveyor Chains with Attachments

Small Roller Type

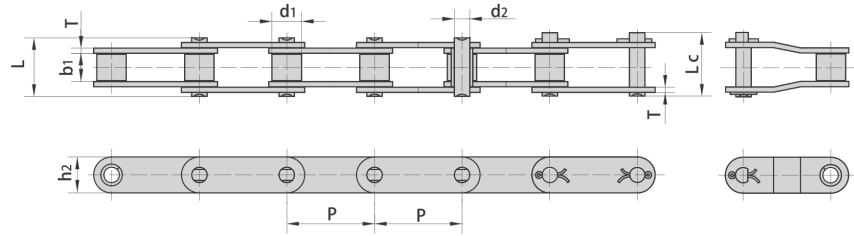

Large Roller Type

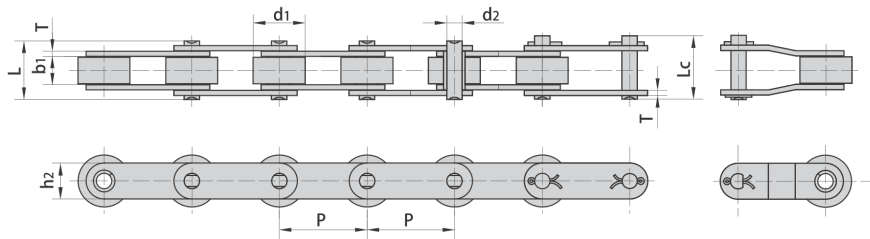

ISO Number	Pitch (P)	Roller Diameter (d1)	Width between Inner Plate (b1)	Pin Diameter (d2)	Pin Length (L)	Pin Length (Lc)	Inner Plate Depth (h2)	Plate Thickness (t/T)	Ultimate Tensile Strength (Q)	Average Tensile Strength (Q)	Weight
	max	max mm	min mm	max mm	max mm	max mm	max mm	max mm	min kN	min kN	kg/m
C2040SS	25.400	7.95	7.85	3.96	16.60	17.80	12.00	1.50	9.60	11.00	0.51
C2042SS	25.400	15.88	7.85	3.96	16.60	17.80	12.00	1.50	9.60	11.00	0.85
C2040HSS	25.400	7.95	7.85	3.96	18.80	19.90	12.00	2.03	9.60	11.00	0.66
C208BSS	25.400	8.51	7.75	4.45	16.70	18.20	11.80	1.60	12.00	13.80	0.56
C208BLSS	25.400	15.88	7.75	4.45	16.70	18.20	11.80	1.60	12.00	13.80	0.90
C2050SS	31.750	10.16	9.40	5.08	20.70	22.20	15.00	2.03	15.20	17.50	0.79
C2052SS	31.750	19.05	9.40	5.08	20.70	22.20	15.00	2.03	15.20	17.50	1.29
C2060SS	38.100	11.91	12.57	5.94	25.90	27.70	18.00	2.42	21.70	24.90	1.13
C2062SS	38.100	22.23	12.57	5.94	25.90	27.70	18.00	2.42	21.70	24.90	1.63
C2060HSS	38.100	11.91	12.57	5.94	29.20	31.60	18.00	3.25	21.70	24.90	1.46
C2062HSS	38.100	22.23	12.57	5.94	29.20	31.60	18.00	3.25	21.70	24.90	2.10
C2080SS	50.800	15.88	15.75	7.92	32.70	36.50	24.00	3.25	38.90	44.70	2.11
C2082SS	50.800	28.58	15.75	7.92	32.70	36.50	24.00	3.25	38.90	44.70	3.16
C2080HSS	50.800	15.88	15.75	7.92	36.20	39.40	24.00	4.00	38.90	44.70	2.57
C2082HSS	50.800	28.58	15.75	7.92	36.20	39.40	24.00	4.00	38.90	44.70	3.63
C2100SS	63.500	19.05	18.90	9.53	40.40	44.70	30.00	4.00	60.00	69.00	3.05
C2102SS	63.500	39.67	18.90	9.53	40.40	44.70	30.00	4.00	60.00	69.00	4.89
C2100HSS	63.500	19.05	18.90	9.53	43.60	46.90	30.00	4.80	60.00	69.00	3.61
C2102HSS	63.500	39.67	18.90	9.53	43.60	46.90	30.00	4.80	60.00	69.00	5.45

# Stainless Steel Double Pitch Conveyor Chains with Attachments

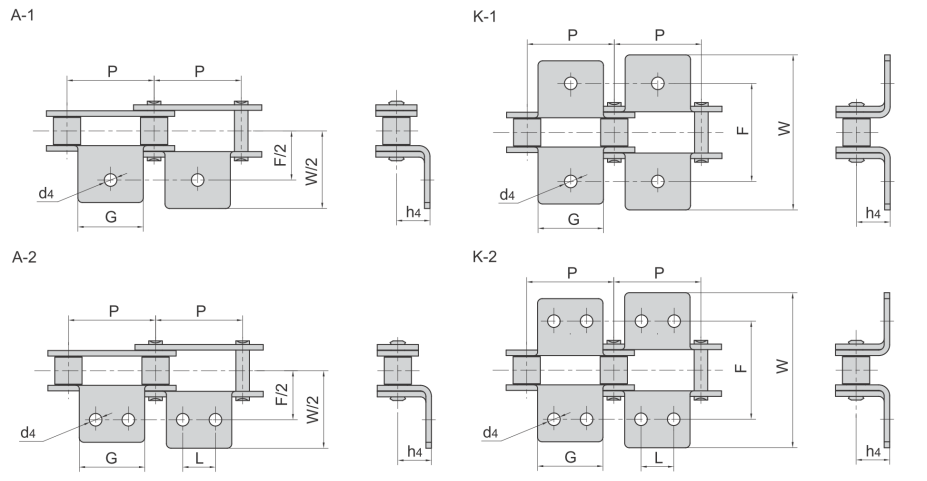

ISO Number	Pitch (P)	G	L	F	W	h4	d4
	max mm	max mm	min mm	max mm	max mm	max mm	max mm
C2040SS	25.400	19.10	9.50	25.40	39.60	9.10	3.40
C2042SS	25.400	19.10	9.50	25.40	39.60	9.10	3.40
C208BSS	25.400	23.20	12.70	25.40	39.60	9.10	4.50
C208BLSS	25.400	23.20	12.70	25.40	39.60	9.10	4.50
C2050SS	31.750	23.80	11.90	31.80	49.00	11.10	5.50
C2052SS	31.750	23.80	11.90	31.80	49.00	11.10	5.50
C2060SS	38.100	28.60	14.30	42.90	67.80	14.70	5.50
C2062SS	38.100	28.60	14.30	42.90	67.80	14.70	5.50
C2060HSS	38.100	28.60	14.30	42.90	67.80	14.70	5.50
C2062HSS	38.100	28.60	14.30	42.90	67.80	14.70	5.50
C2080SS	50.800	38.10	19.10	55.60	87.80	19.10	6.80
C2082SS	50.800	38.10	19.10	55.60	87.80	19.10	6.80
C2080HSS	50.800	38.10	19.10	55.60	87.80	19.10	6.80
C2082HSS	50.800	38.10	19.10	55.60	87.80	19.10	6.80
C2100SS	63.500	47.60	23.80	66.60	107.50	23.40	9.20
C2102SS	63.500	47.60	23.80	66.60	107.50	23.40	9.20
C2100HSS	63.500	47.60	23.80	66.60	107.50	23.40	9.20
C2102HSS	63.500	47.60	23.80	66.60	107.50	23.40	9.20





# Selections of Lubrications

Lubrication of Chain depends on the working environment, temperature, chain speed and so on.

## 1. Working Environment

For opened-drive system, such as combine, swather, etc, please use grease to lubricate. As for closed-drive system, such as walking tractor, etc, please use oil to lubricate.

## 2. Temperature

Application in temperature range of -5 to +60°C is recommended.

## 3. Chain Speed

The lubrication method varies on operating speed of the chain. In selecting lubrication method, please refer to the following chart.

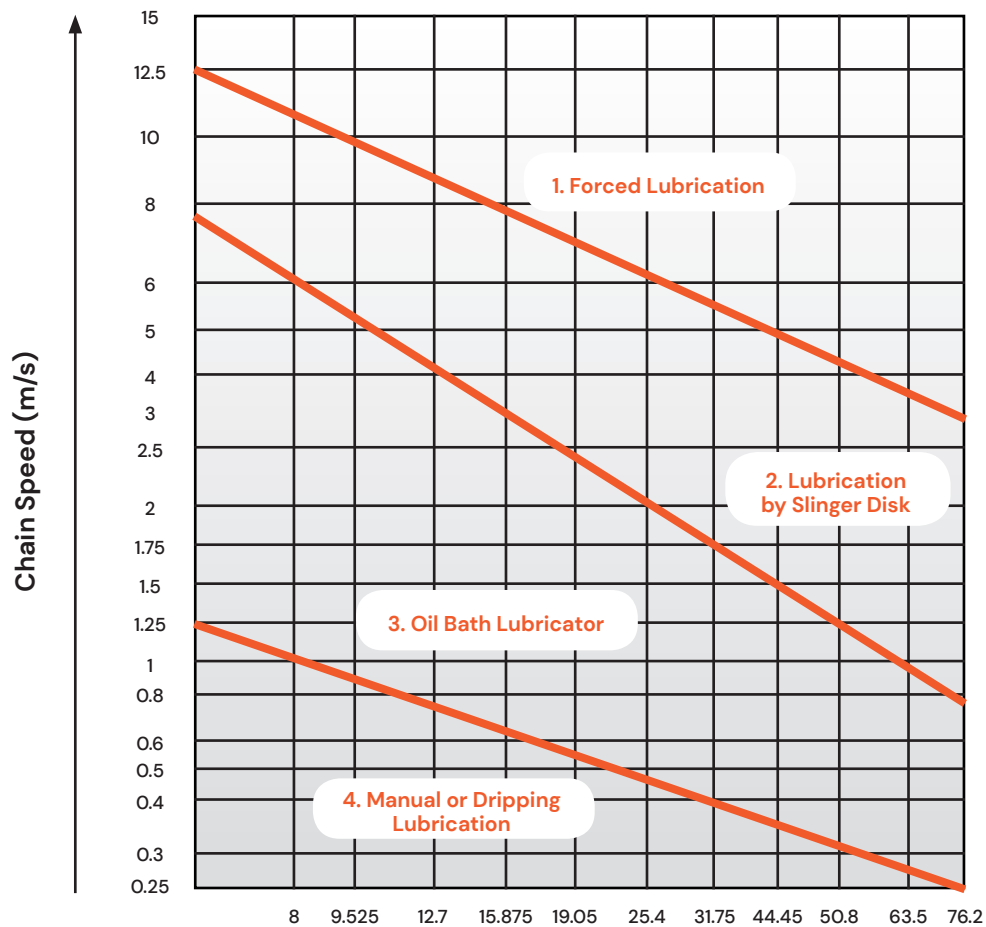

# Selections of Chain-Driven Power

ISO10823-1996 has been used internationally on the selection of roller chain drives. Please use the following guidance to determine the input power

$$\text{Actual Power} = \text{Input Power} \times \text{Service Factor} \times \text{Strand Factor}$$

## Service Factor Table

Load Type	Source of Power		
	International Combustion Engine Hydraulic drive	Electric Motor Turbine	Internal Combustion Mechanical Drive
Smooth	1.0	1.0	1.2
Moderate Impact	1.2	1.3	1.4
High Impact	1.4	1.5	1.7

## Strand Factor Table

Number of Strand	1	2	3	4	5	6
Factor	1.0	1.7	2.5	3.3	4.1	4.9

In order to select the drive power or chain type, we can refer to ISO 10823-1996.

As an example, we will use the transmission parts in walking tractor and transmission power in rotary tillage to determine the chain type.

Information on the number of the small sprocket's teeth & its RPM will be needed.

### 1. Chain Drive Part

Small Sprocket RPM  $n_1 = 1351$   
 Tooth Number of Small Sprocket  $Z_1 = 14$   
 Input Power = 10.944 HP = 8.16 kW

### 2. Rotary Tillage Chain Part

Small Sprocket RPM  $n_1 = 199$   
 Tooth Number of Small Sprocket  $Z_1 = 13$   
 Input Power = 9.888 HP = 7.37 kW

From A series horse power rating graph, we will find that selected 12A-2 roller chain is unsuitable. Instead, we should choose 16A-1 or 12AH-2 roller chain.



**DURALINK**

PRODUCT OF DURAVAZ

Distributor:

A large white rectangular area intended for a distributor's name or contact information.